



## 328 Neath Road, Plasmarl, Swansea, SA6 8JU

**£99,950**

Offered for sale with No Chain a two bedroom terrace property conveniently situated for Morfa Retail Park, City Centre, M4 and amenities.

The accommodation comprises of an entrance porch, hallway, lounge/dining room and a kitchen on the ground floor. On the first floor you will find two bedroom and the bathroom. The property benefits from gas heating, double glazing and a rear garden. EPC Rating - D.

## The Accommodation Comprises

### Ground Floor

#### Porch

Entered via double glazed door to front.

#### Hall

Staircase to first floor, radiator.

#### Lounge 9'8" x 10'10" (2.94m x 3.29m)



Double glazed window to front, radiator, open plan to the dining area.

#### Dining Area 10'10" x 10'10" (3.31m x 3.29m)



Under-stairs storage cupboard, radiator.

#### Kitchen 6'5" x 14'4" (1.96m x 4.37m)



Fitted with a range of wall and base units with worktop space over, stainless steel sink with tiled splashbacks, plumbing for washing machine, space for fridge/freezer and cooker with electric point, double glazed window and door to rear, radiator.

### First Floor

#### Landing

Storage cupboard.

#### Bedroom 1 10'2" x 14'4" (3.09m x 4.37m)



Double glazed window to front, radiator.

#### Bedroom 2 10'10" x 8'6" (3.31m x 2.59m)



Double glazed window to rear, wall mounted boiler, radiator.

## Bathroom



Three piece suite comprising bath with shower, wash hand basin and WC. Tiled splashbacks, frosted double glazed window to rear, tiled flooring, radiator.

## External



To the front of the property is a forecourt garden.

The rear garden is terraced and enclosed.

## Floor Plan

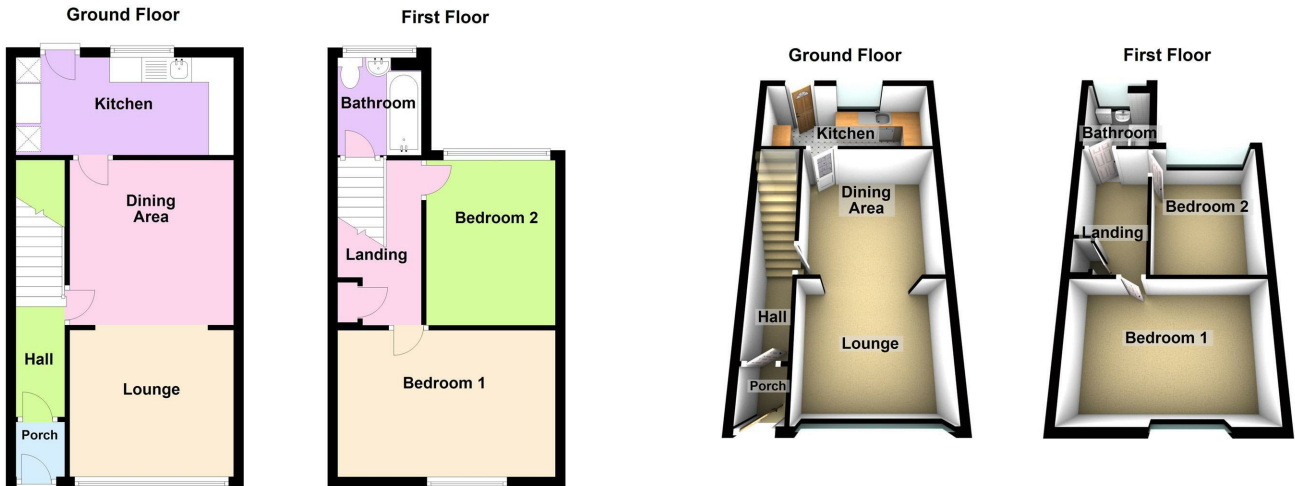

## Area Map



## Energy Efficiency Graph

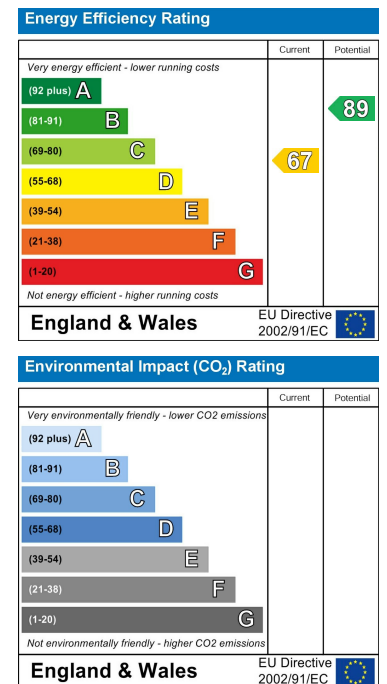

These particulars, whilst believed to be accurate are set out as a general outline only for guidance and do not constitute any part of an offer or contract. Intending purchasers should not rely on them as statements of representation of fact, but must satisfy themselves by inspection or otherwise as to their accuracy. No person in this firm's employment has the authority to make or give any representation or warranty in respect of the property.